

# Dosing Pump (Mains Operated)

The BioDose Dosing Pump (Mains Operated) is a simple, easy and intuitive dosing device to be installed in kitchens for the removal of fats in drain pipes, grease separator systems or other places where dosing at certain intervals of the day is required.

Its peristaltic dosing pump measures and delivers a pre-programmed quantity of BioFax grease digesting enzyme into the drain or grease trap, breaking up the fats and oils that cause blockages, overflows and unpleasant odours and allowing them to be washed away.

## KEY FEATURES

- Delivery of a BioFax Enzyme at predetermined timed intervals
- Intermittent dosage at maximum speed
- Maximum 1 feed per hour
- Programmable initial delay time, interval between dosages and dosing time.
- Quick and easy installation
- Low maintenance, robust design
- Programming password protection
- Dust-tight IP65 enclosure protects against water jets
- Digital interface with 4 digits 7 segments display and 2 keys
- Includes wall mount bracket and fixing screws



## DIMENSIONS mm

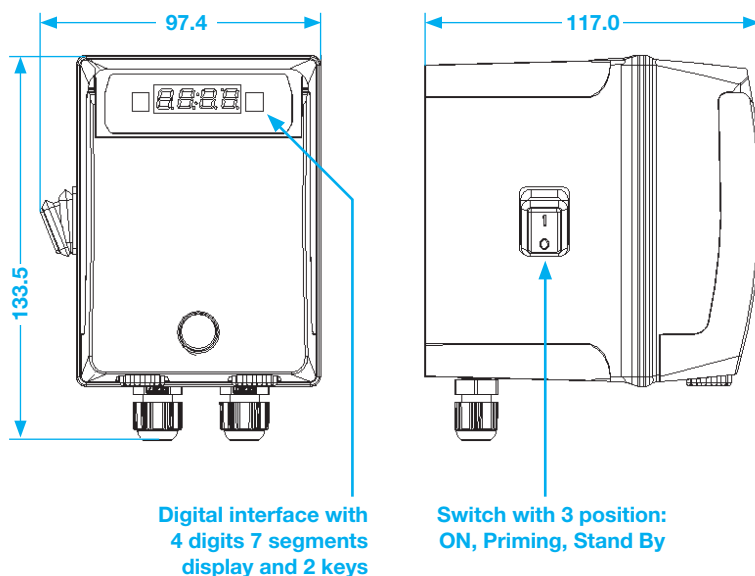

## WASTE TYPE



Grey

### Need help choosing grease management products for your kitchen?

Call our Sales Team on 01442 211554 for free no-obligation advice including how to comply with local authority and landlord regulations. We offer site surveys, installation and servicing.

## TECHNICAL DATA

Power supply	230 V 50 Hz
Appliance class	Class II (no earth req.) ☐
Power	5 W
Pump type	Peristaltic
Flow rate	7 l/h, fixed, intermittent
Pressure	1 bar
Operating temp	5°–50°
Enclosure material	Reinforced polypropylene
Pump head material	Reinforced polypropylene
Squeeze tube	Santoprene
Ingress protection	IP65

### BioFax grease digesting enzyme, concentrated, 10 litres

#28004



To order please visit [www.edincare.com](http://www.edincare.com), call 01442 211554 or email [sales@edincare.com](mailto:sales@edincare.com)

## DELIVERING PUMPED AND DRAINAGE SOLUTIONS FOR OVER 30 YEARS

Packaged pumping stations

Waste water pumping systems

Macerators and macerating toilets

Floor mounted pumping stations

Fat, oil and grease separating systems

Rainwater harvesting systems

Battery backup systems

Adoptable pumping stations

Submersible pumps

Accessories



We provide pumped and drainage products and services to the public and private sectors including residential, commercial, hospitality and retail. We are proud of the long-term relationships we have built with clients and partners, delivering cost effective, robust and dependable products and services.

### PROJECT SERVICES

- Project design
- Site surveys
- Installations
- Refurbishments

### AFTERSALES SERVICES

- Planned servicing
- Emergency call outs
- Commissioning
- Monitoring

### DRAINAGE SERVICES

- Tankering
- Drain maintenance
- Surveys and investigations
- Repairs

### 12-MONTH GUARANTEE

Your products are protected by a 12-month guarantee. [Terms and Conditions](#) apply.

### HOW TO ORDER

Order online at [www.edincare.com](http://www.edincare.com)

Call Sales on 01442 211554

Email [sales@edincare.com](mailto:sales@edincare.com)

### [www.edincare.com](http://www.edincare.com)

- Discover our products and services
- Order products online
- Case studies and articles
- Brochures and technical documents

## Protect your property with an Edincare Service Agreement

As with all pumped and drainage systems, regular maintenance is essential to ensure optimum performance and minimal downtime. Our Service Agreements comprises planned preventive maintenance visits at an agreed frequency, we also service other manufacturers' equipment regardless of type, make and age.

- ✓ Validates your building insurance
- ✓ Reduces the risk of failure
- ✓ Increases the life expectancy of your equipment
- ✓ Priority callouts and 24/7 out-of-hours service
- ✓ Reduced rates for emergency call outs
- ✓ Flexible payment options (Direct Debit)



+44 (0)1442 211554  
[info@edincare.com](mailto:info@edincare.com)

[www.edincare.com](http://www.edincare.com)  
[edincarepumps](https://www.edincare.com)

Unit 7, Heron Business Park, Eastman Way,  
Hemel Hempstead, Hertfordshire, HP2 7FW

A Tricel Company  
[www.tricel.ie](http://www.tricel.ie)



Our policy is one of continuous product improvement, we reserve the right to change specifications and prices without prior notice. All information is given in good faith. No responsibility can be accepted for errors, omissions or incorrect assumptions.  
© 2025 Omni Pump International Ltd t/a Edincare Pumps & Edincare Drains.