



The PowerSafe stores power in case of a mains power loss, protecting your property from flooding. The PowerSafe is completely automatic.

The PowerSafe range of fully automatic battery back up systems are designed to offer your customer peace of mind for their basement drainage. The system can be used on single or dual pump configurations and is suitable for ground, surface, storm, grey and foul water applications.

An optional GSM telemetry system is available for complete monitoring of your pumped drainage system (not available on the PowerSafe ECO).

The PowerSafe system is suitable for installing either at the initial building stage, or retrofitting to existing buildings. It includes a PowerSafe control panel, cable cover, battery holder and batteries (number of batteries specified at time of order).

TECHNICAL FEATURES

- Hand/Off/Auto switches
- High level audible alarm with mute button
- Duty/Assist configuration (alternates switching of pumps)
- Visual indication for: (Supply On, Pumps Running, Pumps Tripped & High Level)
- Available in both single and dual pump configuration.
- Single-phase power supply 230V
- Automatic battery charger
- LCD backlit display*
- Hour run meter*
- Number of starts meter*
- Overload protection
- Reporting of scheduled maintenance*
- Automatic load TEST*
- General alarm output
- Removable front door
- Steel box painted with powder, protection IP31
- Optional telemetric GSM module for remote monitoring and SMS / email alerts*
- Rechargeable sealed batteries

* Not available on PowerSafe ECO.

DIMENSIONS

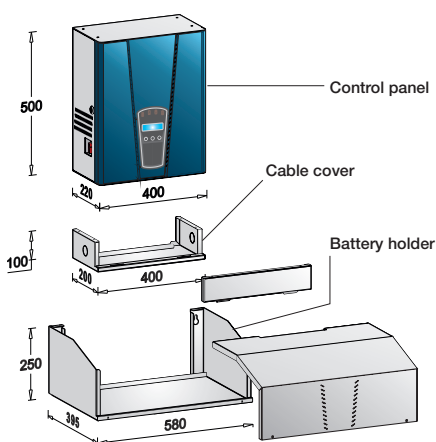

PowerSafe ECO

The battery is included in the control panel.
For dimensions consider only the control panel.

SUITABLE FOR



Above ground



New build



Retro-fit

WASTE TYPE



Grey



Foul



Ground



Surface



Storm

SPECIFICATIONS

PowerSafe ECO

Single (S) / Twin (T) / Control Panel (CP)

Model /Code			Endurance	Batteries	Holder	Cables	kg
S	T	CP					
PowerSafe ECO 600 (up to 370W, 2.1A)							
37001	37101	37201	1 hours	1x50 Ah	–	–	28
37002	37102	37202	1.5 hours	1x60 Ah	–	–	30
37003	37103	37203	2 hours	1x80 Ah	–	–	32

PowerSafe

Single (S) / Twin (T) / Control Panel (CP)

Model /Code			Endurance	Batteries	Holder	Cables	kg
S	T	CP					
PowerSafe 900 (up to 450W, 3.1A)							
37004	37104	37204	1 hour	2x54 Ah	1	1xPB1	51
37005	37105	37205	2 hours	2x80 Ah	1	1xPB1	55
37006	37106	37206	3 hours	2x100 Ah	1	1xPB1	75
37007	37107	37207	4 hours	4x80 Ah	2	2xPB1 + 2xPB2	101
PowerSafe 1300 (up to 600W, 4.8A)							
37008	37108	37208	1 hour	2x80 Ah	1	1xPB1	60
37009	37109	37209	2 hours	2x100 Ah	1	1xPB1	76
37010	37110	37210	3 hours	4x80 Ah	2	2xPB1 + 2xPB2	102
37011	37111	37211	4 hours	4x100 Ah	2	2xPB1 + 2xPB2	134
PowerSafe 1700 (up to 750W, 6.1A)							
37012	37112	37212	1 hour	2x100 Ah	1	1xPB1	81
37013	37113	37213	2 hours	4x80 Ah	2	2xPB1 + 2xPB2	107
37014	37114	37214	3 hours	4x100 Ah	2	2xPB1 + 2xPB2	139
37015	37115	37215	4 hours	8x80 Ah	3	4xPB1 + 6xPB2	186
PowerSafe 2100 (up to 1100W, 7.7A)							
37016	37116	37216	1 hour	3x80 Ah	1	2xPB1	84
37017	37117	37217	2 hours	6x80 Ah	2	4xPB1 + 2xPB2	144
37018	37118	37218	3 hours	6x100 Ah	2	4xPB1 + 2xPB2	192
37019	37119	37219	4 hours	9x100 Ah	3	6xPB1 + 4xPB2	276
PowerSafe 2600 (up to 1300W, 9.9A)							
37020	37120	37220	1 hour	3x80 Ah	1	2xPB1	86
37021	37121	37221	2 hours	6x80 Ah	2	4xPB1 + 2xPB2	146
37022	37122	37222	3 hours	6x100 Ah	2	4xPB1 + 2xPB2	194
37023	37123	37223	4 hours	9x100 Ah	3	6xPB1 + 4xPB2	278
PowerSafe 3100 (up to 1500W, 11.8A)							
37024	37124	37224	1 hour	3x100 Ah	1	2xPB1	114
37025	37125	37225	2 hours	6x100 Ah	2	4xPB1 + 2xPB2	198
37026	37126	37226	3 hours	9x100 Ah	3	6xPB1 + 4xPB2	282
37027	37127	37227	4 hours	12x100 Ah	4	8xPB1 + 6xPB2	366
PowerSafe 4100 (up to 2000W, 15.6A)							
37028	37128	37228	0.5 hours	3x80 Ah	1	2xPB1	96
37029	37129	37229	1 hour	6x80 Ah	2	4xPB1 + 2xPB2	156
37030	37130	37230	1.5 hours	6x100 Ah	2	4xPB1 + 2xPB2	204
37031	37131	37231	2 hours	12x80 Ah	4	8xPB1 + 6xPB2	276
PowerSafe 5100 (up to 2300W, 20.0A)							
37032	37132	37232	0.5 hours	3x100 Ah	1	2xPB1	126
37033	37133	37233	1 hour	6x100 Ah	2	4xPB1 + 2xPB2	210
37034	37134	37234	1.5 hours	9x100 Ah	3	6xPB1 + 4xPB2	294
37035	37135	37235	2 hours	12x100 Ah	4	8xPB1 + 6xPB2	378

All our products can be customised to your requirements.

For more information on this please contact our sales team on 01442 211554.

MODELS

PowerSafe S

Provides power to a single automatic pumps.

PowerSafe T

Provides power to two automatic pumps.

PowerSafe CP

Operates in conjunction with a control panel to provide power to manual pumps.

PowerSafe.S ECO SINGLE AUTOMATIC PUMP

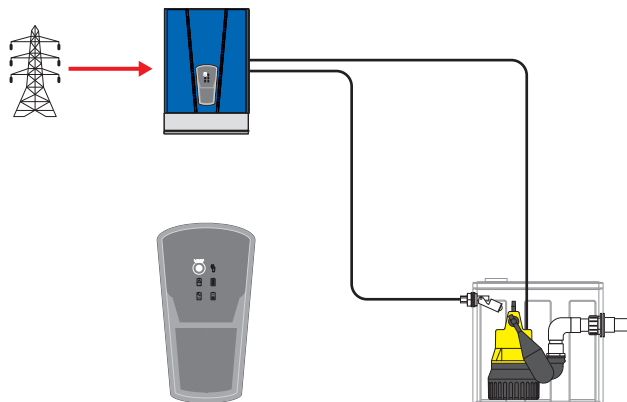

PowerSafe.S SINGLE AUTOMATIC PUMP

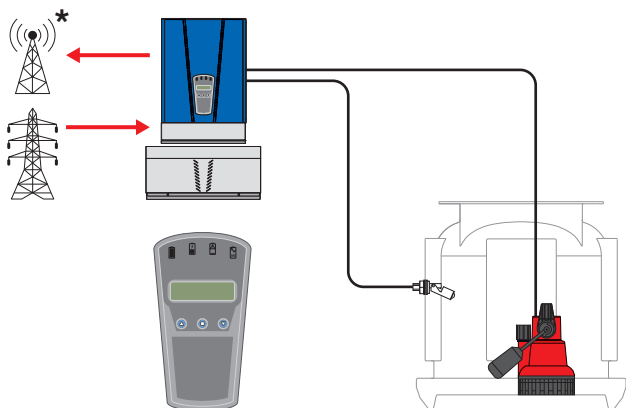

PowerSafe.T DUAL AUTOMATIC PUMPS

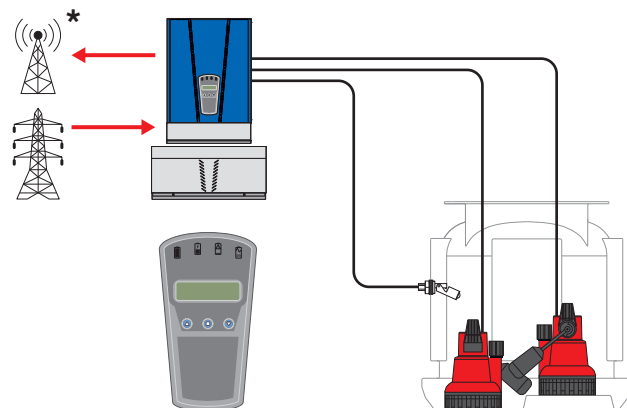

PowerSafe.CP SINGLE MANUAL PUMP WITH CONTROL PANEL

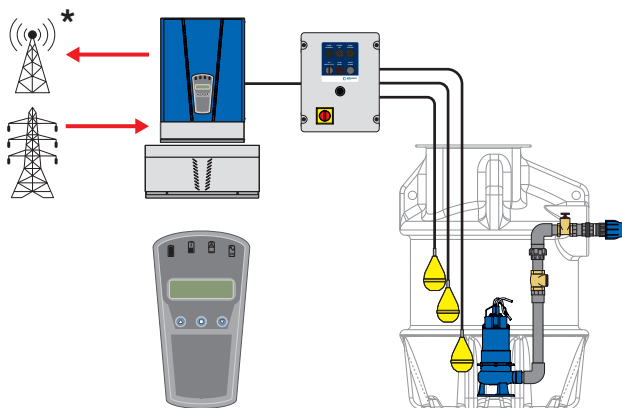

PowerSafe.CP TWIN MANUAL PUMPS WITH CONTROL PANEL

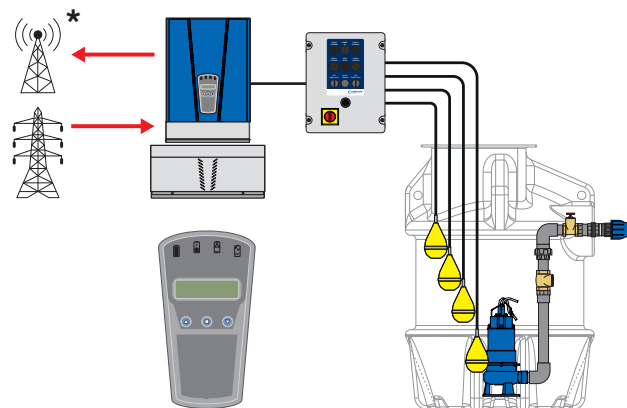

* An optional GSM module is required for remote monitoring and SMS/email alerts (not available on PowerSafe ECO).

DELIVERING PUMPED AND DRAINAGE SOLUTIONS FOR OVER 25 YEARS

Packaged pumping stations

Waste water pumping systems

Macerators and macerating toilets

Floor mounted pumping stations

Fat, oil and grease separating systems

Rainwater harvesting systems

Battery backup systems

Adoptable pumping stations

Accessories



We provide pumped and drainage products and services to the public and private sectors, including residential, commercial, hospitality and retail.

We are proud of the long-term relationships we have built with our clients and partners, delivering cost effective, robust and dependable products and services.

12-MONTH GUARANTEE

Your products are protected by a 12-month guarantee. Please refer to our Terms and Conditions at www.edincare.com

HOW TO ORDER

Order online at www.edincare.com
Call Sales on 01442 211554
Email sales@edincare.com

PROJECT SERVICES

- Project design
- Site surveys
- Installations
- Refurbishments

AFTERSALES SERVICES

- Planned servicing
- Emergency call outs
- Commissioning
- Monitoring

DRAINAGE SERVICES

- Tankering
- Jetting
- Drainage CCTV
- Surveys

www.edincare.com

- Discover our products and services
- Order products online
- Case studies and articles
- Brochures and technical documents

Protect your property with an Edincare Service Agreement

As with all pumped and drainage systems, regular maintenance is essential to ensure optimum performance and minimal downtime. Our Service Agreements comprises planned preventive maintenance visits at an agreed frequency, we also service other manufacturers' equipment regardless of type, make and age.

- ✓ Validates your building insurance
- ✓ Reduces the risk of failure
- ✓ Increases the life expectancy of your equipment
- ✓ Priority callouts and 24/7 out-of-hours service
- ✓ Reduced rates for emergency call outs
- ✓ Flexible payment options (Direct Debit)



+44 (0)1442 211554
info@edincare.com

www.edincare.com
[Twitter](#) [LinkedIn](#) [Facebook](#) [Instagram](#) [YouTube](#) [WhatsApp](#) [Snapchat](#) [Pinterest](#) [Tumblr](#) [Vimeo](#) [SoundCloud](#) [Dribbble](#) [Behance](#) [Flickr](#) [DeviantArt](#) [500px](#) [Flickr](#) [DeviantArt](#) [500px](#) [Flickr](#) [DeviantArt](#) [500px](#)

Unit 8, Heron Business Park, Eastman Way,
Hemel Hempstead, Hertfordshire, HP2 7FW

Part of the Edincare Group of Companies www.edincaregroup.com



Our policy is one of continuous product improvement, we reserve the right to change specifications and prices without prior notice. All information is given in good faith. No responsibility can be accepted for errors, omissions or incorrect assumptions. © Omni Pump International Ltd t/a Edincare Pumps & Edincare Drains. All rights reserved.