

# Magna150Cutter

The Magna150Cutter fully automatic packaged pumping station is suitable for pumping grey and foul water to a higher level when gravity drainage is not possible and/or economical to install.

The system provides 150 litre storage capacity, ideal for accepting waste from an extension, outbuilding, basement or similar. Featuring a macerating impellor, the pump offers reliable and effective pumping of grey and foul water. The compact chamber offers ease of installation for sites with limited space.

The system consists of a polyethylene chamber, locking access cover, internal pipework and fittings, one automatic macerating submersible pump and external compression adaptor.

The Magna150Cutter is easy to install as inlets can be positioned to your requirements (inlet information to be supplied at time of order).

## KEY FEATURES

- The macerating impellor enables the maceration and pumping of grey and foul water through small bore pipework.
- Optimised for high head, low flow applications
- Compact chamber for limited space installations
- Ideal for an extension, outbuilding, basement or similar
- Variable inlet positions
- A range of alarms and remote alerts are available offering peace of mind
- Easy to install



## PUMP CURVE

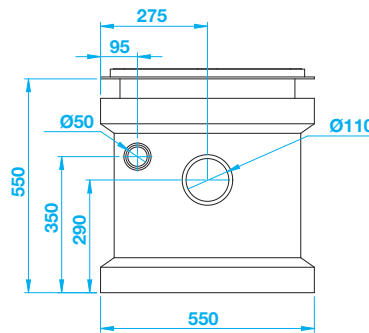
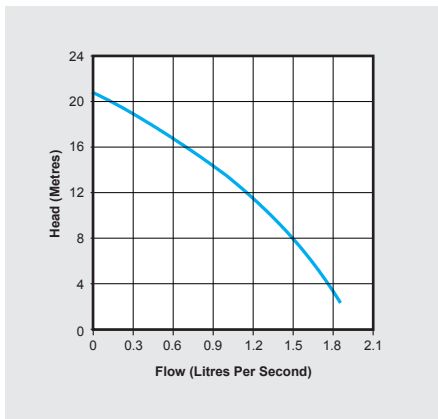

Female compression adaptor  
1 1/4" / 32mm ID

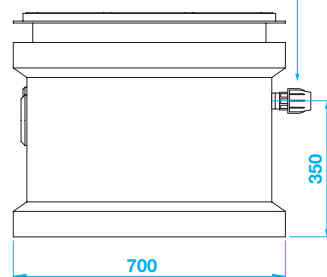

## DIMENSIONS (mm)

CHAMBER	Length	Width	Depth
Magna150	700	550	550
ACCESS COVER	Length	Width	Depth
Clear opening	600	450	-
including frame	640	490	23

## TECHNICAL DATA

CHAMBER	
Discharge pipework	32 mm OD
Lifting eyes	No
Capacity	150 litres
Chamber material	Tank grade polyethylene
Chamber colour	White
Total boxed weight	35 kg
PUMP	
No. of pumps	1
Impellor type	Macerator
Power supply	230V AC
Rated current	6.4A
Motor rating	1000W
Revolutions per minute	2865rpm
Max. vertical output	20m
Max. flow rate	1.8 l/s
Max. liquid temperature	<40°C
Cable length	10m
Colour	Stainless steel / Blue
ACCESS COVER	
Material	Galvanised steel
Loading	Solid Top, PP Frame, (Facta A)
Locking	Yes

## SUITABLE FOR



## WASTE TYPE



## OPTIONAL EXTRAS

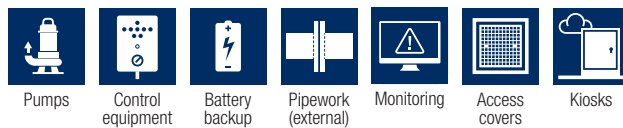

All our products can be customised to your requirements. For more information on this please contact our sales team on 01442 211554.

# DELIVERING PUMPED AND DRAINAGE SOLUTIONS FOR OVER 25 YEARS

- Packaged pumping stations
- Waste water pumping systems
- Macerators and macerating toilets
- Floor mounted pumping stations
- Fat, oil and grease separating systems
- Rainwater harvesting systems
- Battery backup systems
- Adoptable pumping stations
- Submersible pumps
- Accessories



We provide pumped and drainage products and services to the public and private sectors, including residential, commercial, hospitality and retail.

We are proud of the long-term relationships we have built with our clients and partners, delivering cost effective, robust and dependable products and services.

### 12-MONTH GUARANTEE

Your products are protected by a 12-month guarantee. Please refer to our Terms and Conditions at [www.edincare.com](http://www.edincare.com)

### HOW TO ORDER

Order online at [www.edincare.com](http://www.edincare.com)  
 Call Sales on 01442 211554  
 Email [sales@edincare.com](mailto:sales@edincare.com)

### PROJECT SERVICES

- Project design
- Site surveys
- Installations
- Refurbishments

### AFTERSALES SERVICES

- Planned servicing
- Emergency call outs
- Commissioning
- Monitoring

### DRAINAGE SERVICES

- Tankering
- Jetting
- Drainage CCTV
- Surveys
- Cleaning and de-scaling
- Structural repairs
- Excavations
- Root cutting

### [www.edincare.com](http://www.edincare.com)

- Discover our products and services
- Order products online
- Case studies and articles
- Brochures and technical documents

## Protect your property with an Edincare Service Agreement

As with all pumped and drainage systems, regular maintenance is essential to ensure optimum performance and minimal downtime. Our Service Agreements comprises planned preventive maintenance visits at an agreed frequency, we also service other manufacturers' equipment regardless of type, make and age.

- ✓ Validates your building insurance
- ✓ Reduces the risk of failure
- ✓ Increases the life expectancy of your equipment
- ✓ Priority callouts and 24/7 out-of-hours service
- ✓ Reduced rates for emergency call outs
- ✓ Flexible payment options (Direct Debit)



+44 (0)1442 211554  
[info@edincare.com](mailto:info@edincare.com)

[www.edincare.com](http://www.edincare.com)  
 edincarepumps

Unit 8, Heron Business Park, Eastman Way,  
 Hemel Hempstead, Hertfordshire, HP2 7FW

Part of the Edincare Group of Companies [www.edincaregroup.com](http://www.edincaregroup.com)



Our policy is one of continuous product improvement, we reserve the right to change specifications and prices without prior notice. All information is given in good faith. No responsibility can be accepted for errors, omissions or incorrect assumptions. © Omni Pump International Ltd t/a Edincare Pumps & Edincare Drains. All rights reserved.